



GALLIARD HOMES LIMITED

IN JOINT VENTURE WITH  
FROGMORE  
PROPERTY COMPANY LTD

PRESENT

A

WORLD CLASS  
INVESTMENT  
OPPORTUNITY

THE

*Executive*  
COLLECTION



Park Plaza  
Westminster Bridge  
LONDON

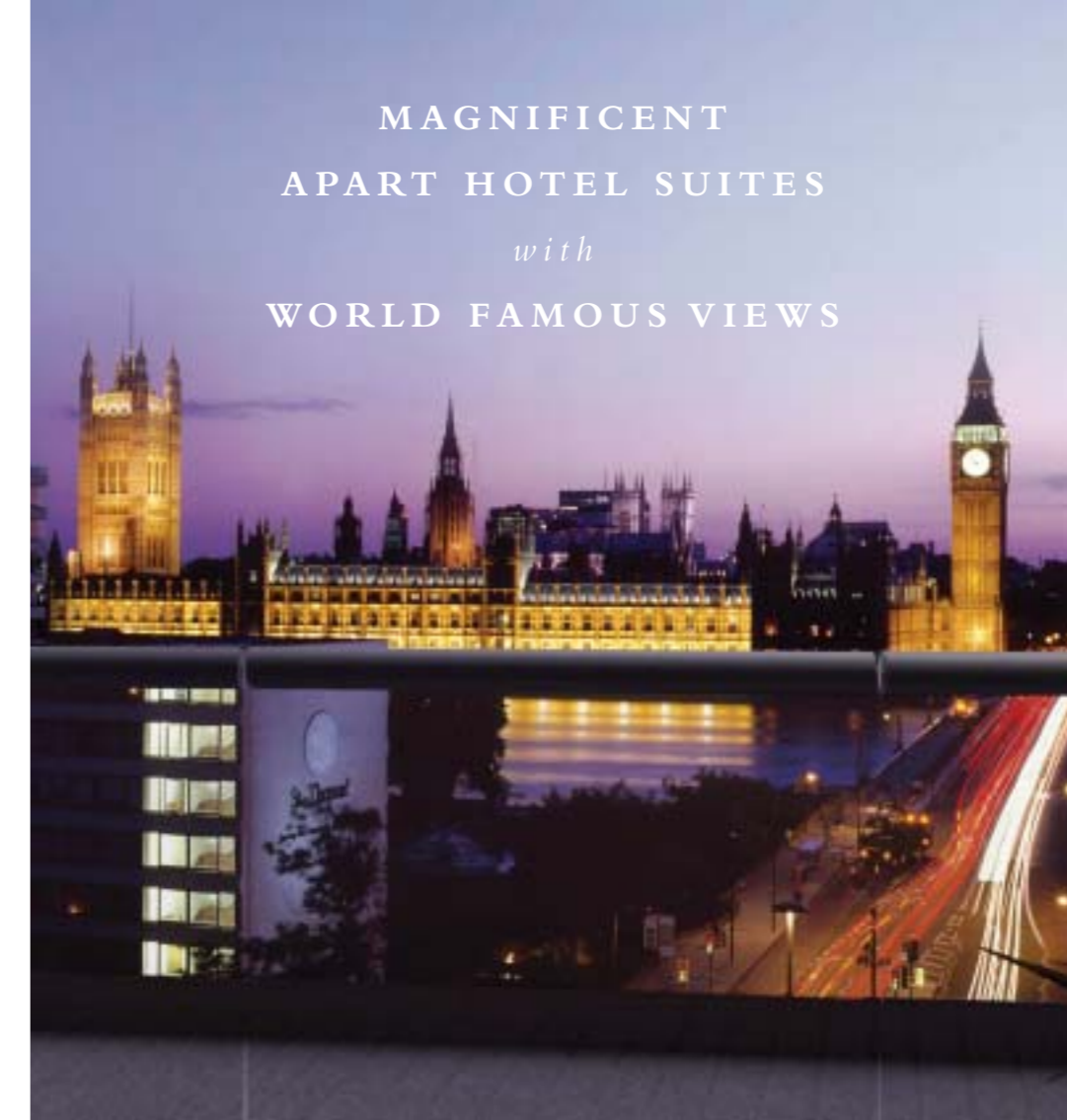

MAGNIFICENT  
APART HOTEL SUITES  
*with*  
WORLD FAMOUS VIEWS

Park Plaza Westminster Bridge will be the Capital's largest and most prestigious new apart hotel offering luxurious, highly sophisticated accommodation for over 900 guests and residents.

The three upper levels, rising some 150 feet above the Thames will provide the ultimate in exclusivity - a collection of Executive Suites overlooking the Houses of Parliament, Big Ben and much of the Capital's dramatic skyline.

**This unique and limited collection has been designed not only as superlative guest suites... but with the potential for nine months occupancy in the heart of London.**

The apart hotel will occupy one of the most strategic and important locations in London. Not only is it directly aligned with Big Ben and within a few hundred metres of Westminster itself, but will be central for the South Bank and its ever changing spectacle of arts, media, theatre and stage.

World class shopping, Savile Row tailoring, the West End's haute couture fashion boutiques, Covent Garden and Theatreland will all be within close proximity of Park Plaza Westminster Bridge.

Residents and guests will also be 2 minutes walk approx. from Waterloo - one of the Capital's largest communication hubs connecting to London's entire tube and mainline transportation network.



Park Plaza Westminster Bridge will be managed and operated by Park Plaza Hotels Europe, becoming the latest and most prestigious of the company's worldwide portfolio.

The hotel will have three 14 storey atrium voids, refined restaurants and dedicated floor levels for banqueting, conferences, functions and fitness & recreation.

The conference facilities will be amongst the largest in London with approximately 14,000 sq.ft. of space, allowing for some 1200 or more delegates - set to generate huge potential from the UK and international corporate and events sectors.



The capital's greatest experiences... within minutes of London's largest new landmark  
**for superlative hospitality**

**Facilities will include:-**

- brasserie restaurant*
- à la carte restaurant*
- coffee bar*
- retail outlets*
- 24 hour concierge*
- porterage*
- conference hall*
- ballroom*
- business lounges*
- executive meeting rooms*
- lounge & bar*
- gymnasium*
- indoor pool*
- gallery lounge*
- hi-tech guest room facilities*





visionary suites  
 setting unprecedented levels of guestroom technology



The executive levels offer a choice of studio and 1 & 2 bedroom suite styles, the majority with a private balcony or terrace - furthering the visual drama and panoramic excellence of London's skyline.

Many suites will also share the breathtaking spectacle of the hotel's atrium voids.

Internal specifications and finishes are currently being specified and detailed from one of the world's leading interior design teams, ensuring every suite will exude in sophisticated style and subtle opulence.

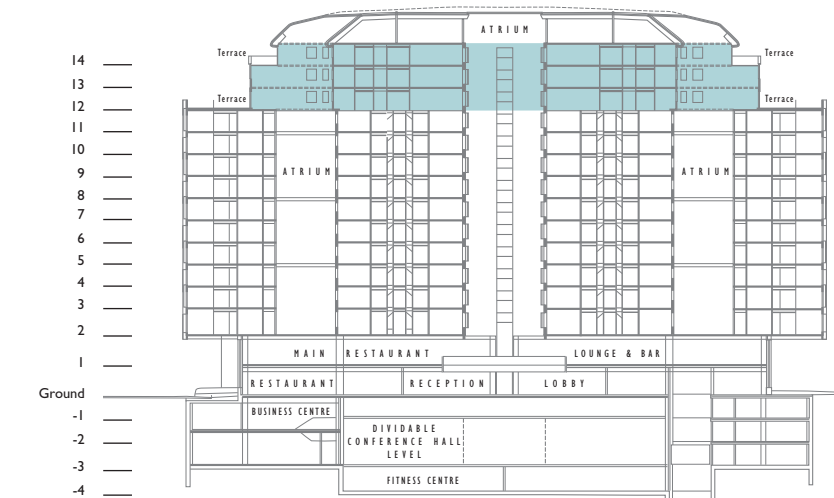

SECTION THROUGH HOTEL



Images are computer generated and shown as a preliminary guide only towards the intended style of interior finish.



Image is computer generated and shown as a preliminary guide only towards the intended style of interior finish.

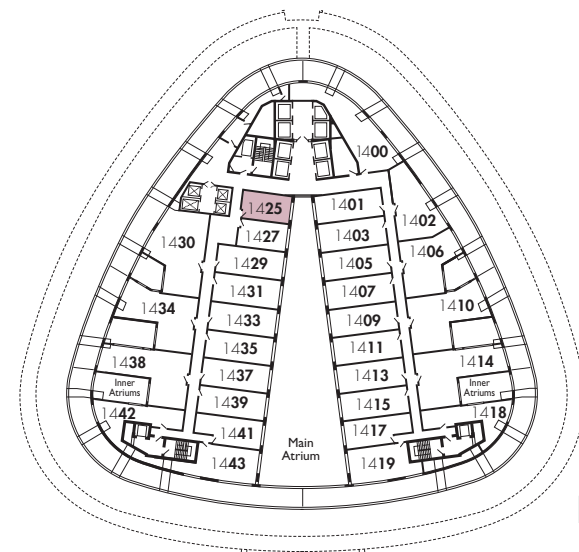

14TH

| SUITE | SQ.M. | SQ.FT. |
|-------|-------|--------|
| 1319  | 24.5  | 264    |
| 1325  | 25.3  | 272    |
| 1327  | 25.3  | 272    |
| 1425  | 25.3  | 272    |



Studio Executive Suites

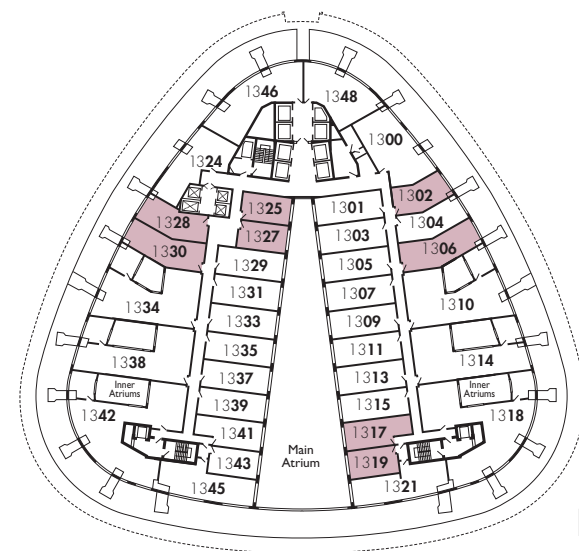

13TH

| SUITE | SQ.M. | SQ.FT. |
|-------|-------|--------|
| 1317  | 31.4  | 338    |

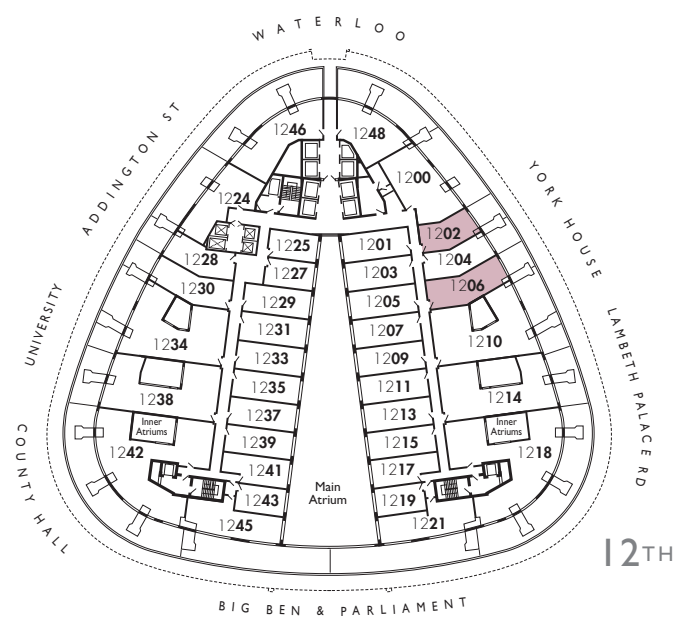

12TH

| SUITE | SQ.M. | SQ.FT.            |
|-------|-------|-------------------|
| 1202  | 29.3  | 315               |
| 1302  | 29.3  | 315               |
|       |       | (without balcony) |
| 1328  | 35.4  | 381               |
|       |       | (without balcony) |
| 1330  | 42.0  | 452               |
|       |       | (without balcony) |

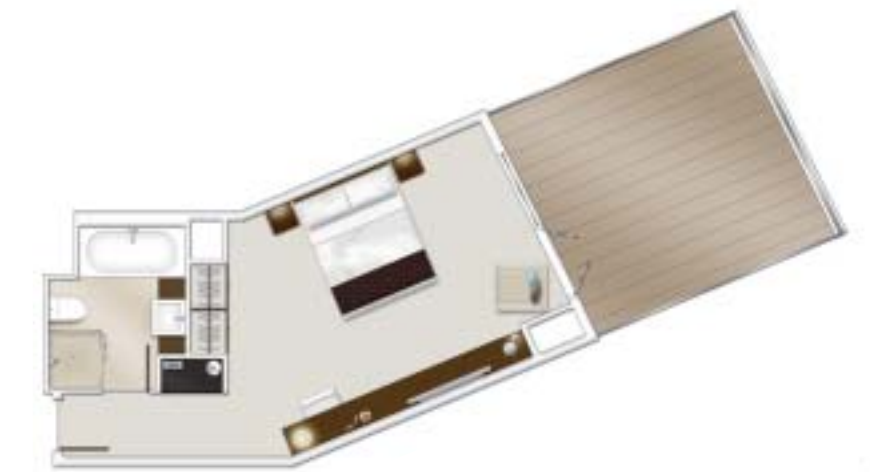

All floor plan layouts are intended to be correct but may vary during architectural finalisation of the building. Floor finishes and furniture are shown as a guide and for illustrative purposes only. Total areas are indicative of the current fully intended scheme but may vary and should be regarded as a guide only.



SUITE SQ.M. SQ.FT.  
34.3 369

|      |      |      |
|------|------|------|
| 1201 | 1301 | 1401 |
| 1203 | 1303 | 1403 |
| 1205 | 1305 | 1405 |
| 1207 | 1307 | 1407 |
| 1209 | 1309 | 1409 |
| 1211 | 1311 | 1411 |
| 1213 | 1313 | 1413 |
| 1215 | 1315 | 1415 |
| 1229 | 1329 | 1429 |
| 1231 | 1331 | 1431 |
| 1233 | 1333 | 1433 |
| 1235 | 1335 | 1435 |
| 1237 | 1337 | 1437 |
| 1239 | 1339 |      |



SUITE SQ.M. SQ.FT.  
1321 56.2 605  
1345 56.2 605

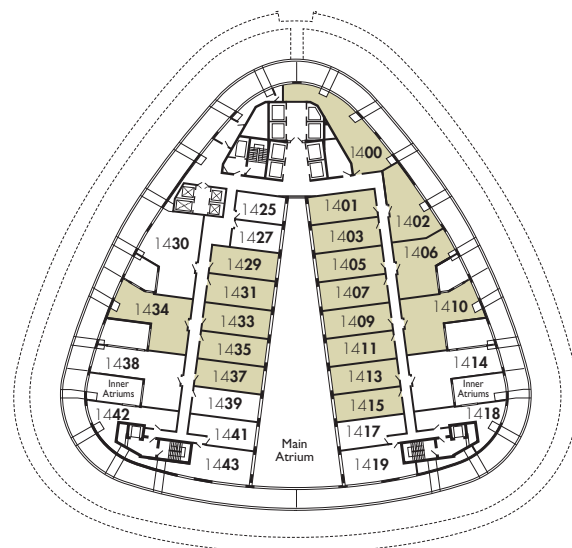

14<sup>TH</sup>

SUITE SQ.M. SQ.FT.  
1402 49.1 529



1 Bedroom  
Executive  
Suites



Atrium Void

SUITE SQ.M. SQ.FT.  
1406 50.9 548



Atrium Void

SUITE SQ.M. SQ.FT.  
1410 64.0 689  
1434 64.0 689

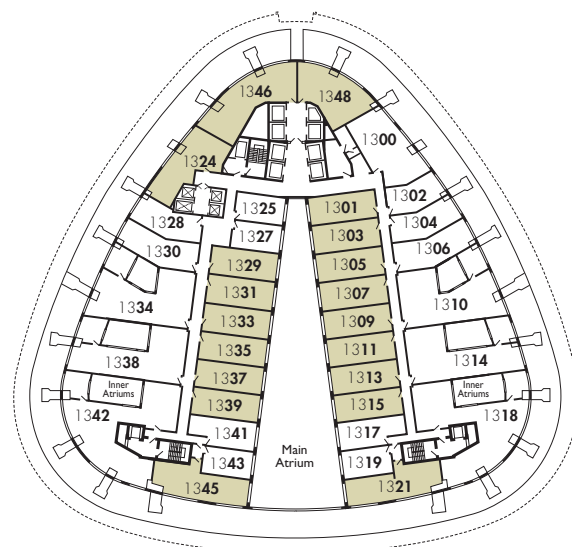

13<sup>TH</sup>

SUITE SQ.M. SQ.FT.  
1248 53.6 577  
1348 59.2 637  
*(without balcony)*

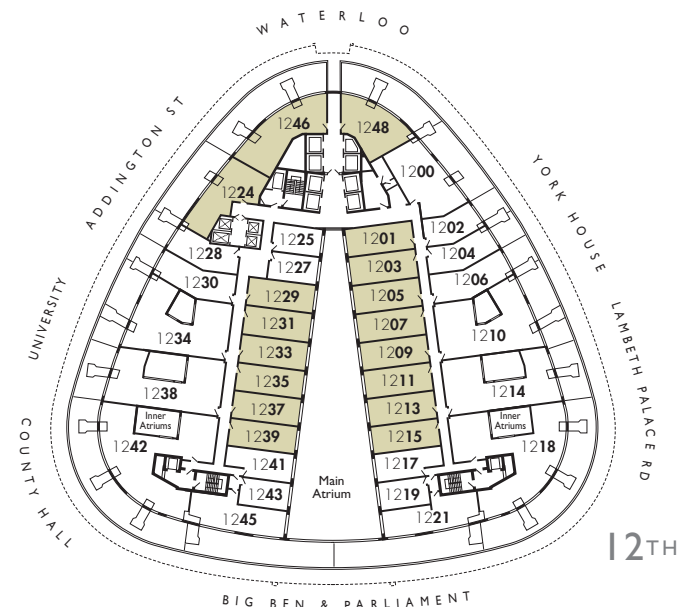

12<sup>TH</sup>



| SUITE | SQ.M. | SQ.FT. |
|-------|-------|--------|
| 1201  | 1301  | 1401   |
| 1203  | 1303  | 1403   |
| 1205  | 1305  | 1405   |
| 1207  | 1307  | 1407   |
| 1209  | 1309  | 1409   |
| 1211  | 1311  | 1411   |
| 1213  | 1313  | 1413   |
| 1215  | 1315  | 1415   |
| 1229  | 1329  | 1429   |
| 1231  | 1331  | 1431   |
| 1233  | 1333  | 1433   |
| 1235  | 1335  | 1435   |
| 1237  | 1337  | 1437   |
| 1239  | 1339  |        |



| SUITE | SQ.M. | SQ.FT. |
|-------|-------|--------|
| 1321  | 56.2  | 605    |
| 1345  | 56.2  | 605    |

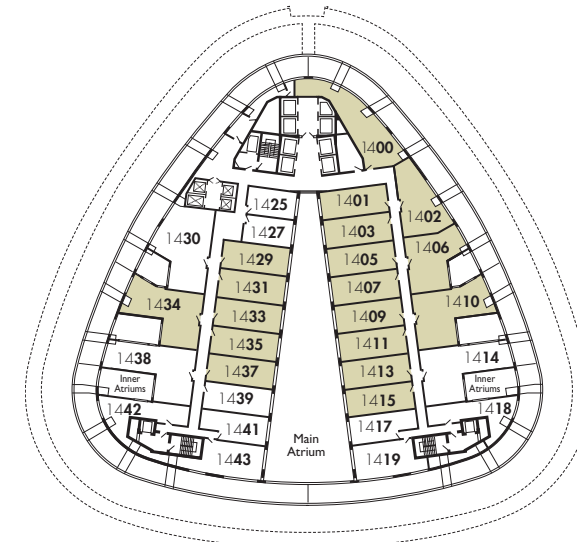

14<sup>TH</sup>

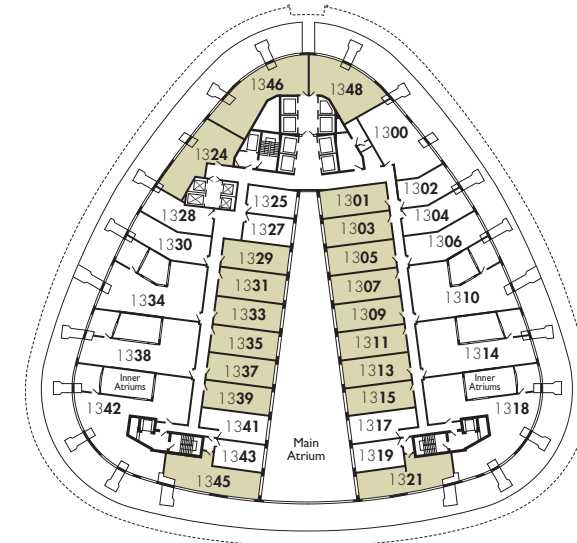

13<sup>TH</sup>

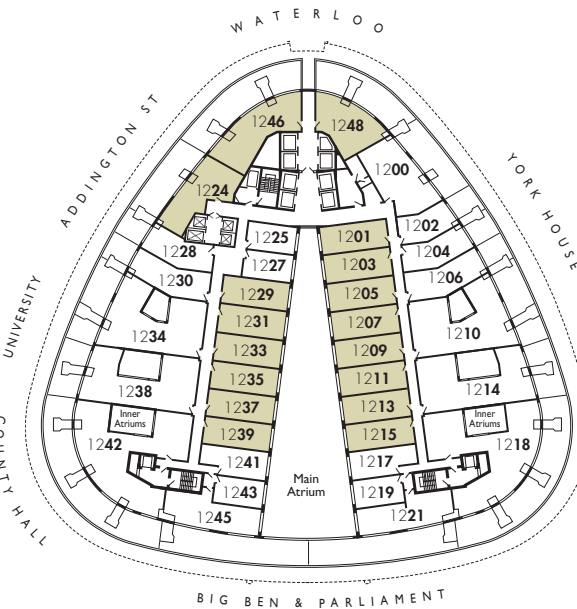

12<sup>TH</sup>



| SUITE | SQ.M. | SQ.FT. |
|-------|-------|--------|
| 1246  | 65.9  | 709    |
| 1346  | 71.5  | 770    |

(without balcony)



| SUITE | SQ.M. | SQ.FT. |
|-------|-------|--------|
| 1400  | 63.8  | 687    |



| SUITE | SQ.M. | SQ.FT. |
|-------|-------|--------|
| 1406  | 50.9  | 548    |



| SUITE | SQ.M. | SQ.FT. |
|-------|-------|--------|
| 1410  | 64.0  | 689    |
| 1434  | 64.0  | 689    |



| SUITE | SQ.M. | SQ.FT. |
|-------|-------|--------|
| 1224  | 55.2  | 594    |
| 1324  | 55.2  | 594    |



1 Bedroom  
Executive  
Suites

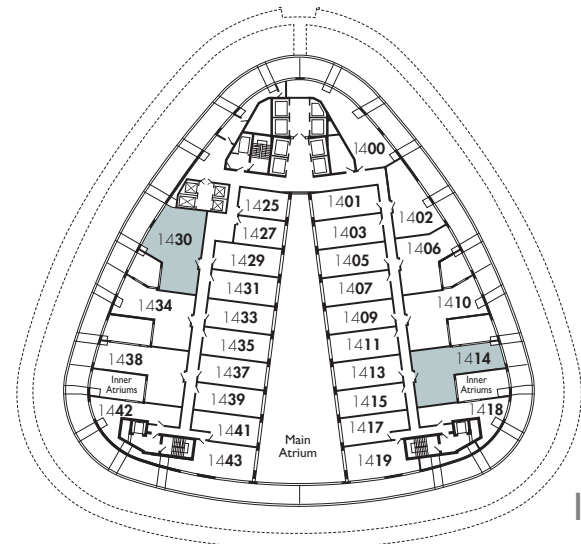

14<sup>TH</sup>

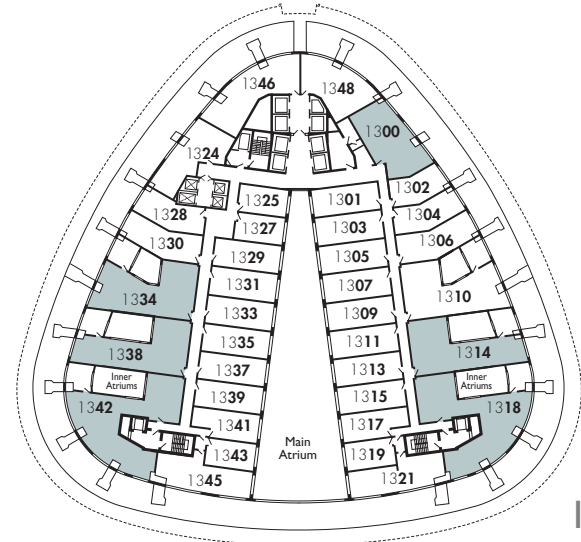

13<sup>TH</sup>

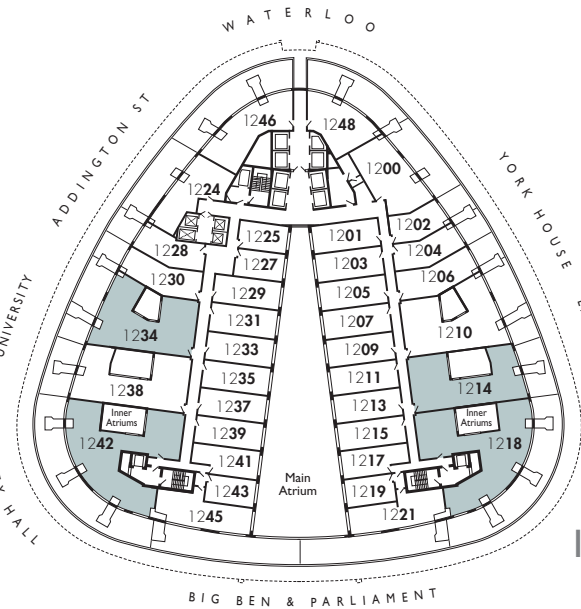

12<sup>TH</sup>



| SUITE | SQ.M. | SQ.FT. |
|-------|-------|--------|
| 1234  | 99.7  | 1073   |
| 1334  | 84.4  | 909    |

(with terrace)



| SUITE | SQ.M. | SQ.FT. |
|-------|-------|--------|
| 1414  | 67.7  | 729    |



| SUITE | SQ.M. | SQ.FT. |
|-------|-------|--------|
| 1300  | 67.8  | 730    |



| SUITE | SQ.M. | SQ.FT. |
|-------|-------|--------|
| 1430  | 76.6  | 825    |

| SUITE | SQ.M. | SQ.FT. |
|-------|-------|--------|
| 1214  | 95.0  | 1023   |
| 1314  | 80.5  | 867    |

(with terrace)

| SUITE | SQ.M. | SQ.FT. |
|-------|-------|--------|
| 1338  | 80.5  | 867    |

(with terrace)

2 Bedroom  
Executive  
Suites

All floor plan layouts are intended to be correct but may vary during architectural finalisation of the building. Floor finishes and furniture are shown as a guide and for illustrative purposes only. Total areas are indicative of the current fully intended scheme but may vary and should be regarded as a guide only. Interiors are computer generated and shown as a preliminary guide only towards the intended style of finish.



2 Bedroom Executive Suite

| SUITE | SQ.M.                 | SQ.FT. |
|-------|-----------------------|--------|
| 1218  | 127.5                 | 1372   |
| 1318  | 109.6                 | 1180   |
|       | <i>(with terrace)</i> |        |
| 1242  | 127.5                 | 1372   |
| 1342  | 109.6                 | 1180   |
|       | <i>(with terrace)</i> |        |



Management with global strength

The last decade has seen a tremendous globalisation in the hospitality industry and Park Plaza Hotels Europe strongly competes with all key hotel industry players in the 4-star segment but without the traditionally high overheads.

The company is one of the most dynamic in the hotel industry, backed by international investors who recognise the competitive edge and the numerous advantages that a broad-based, global approach to the hospitality industry offers.

The company operates from regional offices in London, Amsterdam and Berlin and at the beginning of 2005, had 30 hotels open and under development in 11 countries, mainly under the Park Plaza Hotels & Resorts and art'otel brands.

Park Plaza Hotels Europe also operates the 4-star, boutique-style, Sherlock Holmes Hotel and the 5-star, all-suite, Plaza on the River - Club and Residence, both located in central London.

Through its alliance with Carlson Hotels Worldwide (Regent International Hotels®, Park Plaza Hotels & Resorts®, Radisson Hotels & Resorts®, Country Inns & Suites® and Park Inn®) it has been successful in marketing and further developing the Park Plaza Hotels & Resorts brand in Europe, Middle East & Africa, collectively offering more than 50 hotels in 17 countries worldwide.

Park Plaza Hotels Europe is not only committed to continue growing through leasing and managing hotels but also through franchising and affiliations with carefully selected partners.

Expanding the Park Plaza network of hotels is a main objective. The company will achieve this by ensuring the best product & service delivery to customers. Park Plaza Westminster Bridge will be the latest and most innovatively designed hotel within the company's prestigious worldwide portfolio.

Carlson Marketing Group®

Carlson Cruises Worldwide

Carlson Leisure Group



Carlson Hotels Worldwide

Carlson Restaurants Worldwide



The marks "REGENT INTERNATIONAL HOTELS" "THE REGENT" any combination thereof and the R and Oval R logos are trademarks of Regent Hospitality Worldwide, Inc.

Lambeth Bridge    Battersea    The Houses of Parliament    Westminster Abbey    Big Ben    Portcullis House    Ministry of Defence    Charing Cross    Hungerford Bridge    Somerset House    St Paul's Cathedral    Financial London    Canary Wharf



The information contained in this brochure is believed to be correct but its accuracy cannot be guaranteed and no such information forms part of any contract. Neither the vendors nor their agents or any person in their employ has any authority to make or give any representation or warranty or guarantee (whether written or oral) in respect of or in relation to the development or any part thereof. Galliard reserve the right to alter specifications referred to in this brochure without prior notice. All images of the development within this brochure are computer generated, precise details will vary. All interior photographs are for illustrative purposes only. Floor plan layout shown opposite is intended to be correct but may vary during architectural finalisation of the building. Floor finishes and furniture are shown as a guide and for illustrative purposes only. Total areas are indicative of the current fully intended scheme but may vary and should be regarded as a guide only.



LONDON APART HOTEL MARKETING AND SALES SUITE  
248 WESTMINSTER BRIDGE ROAD, LONDON, SE1 7PD  
**020 7620 1500    020 7928 8619**  
e: [sales@lwestminsterbridge.com](mailto:sales@lwestminsterbridge.com)    [www.lwestminsterbridge.com](http://www.lwestminsterbridge.com)

